

AC Air Source Treatment Unit

Soft Start - up Valve

Specification:

Type	AV200-01,02	AV300-02,03	AC400-03,04
Port size (G)	1/8" .1/4"	1/4" .3/8"	3/8" .1/2"
Fluid	Compressed Air		
Operating pressure range MPa	0.25~0.85		
Ambient temperature °C	-5~60		
Acting type	Electronic control		
Port size (G)	1/4"	3/8"	1/2"
Voltage range	±10%		
Apply to FRL	AC200A-01,02	AC300A-02,03	AC300A-03,04



How to order:

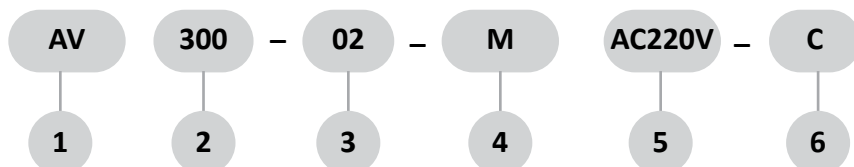

1	AV Soft Start - up Valve
2	Type: 200,300,400
3	Port size: 01:G1/8" , 02:G1/4" , 03:G3/8" , 04:G1/2"
4	M: Embed square gauge; Blank: Round gauge
5	Coil Voltage:DC24V,AC220V 50/60Hz; AC110V 50/60Hz
6	Wiring: Blank:White with ended;C: Browns;W: Lead wire type

Characteristic:

Soft start-up valve is used to input compressed air into pneumatic system slowly and has the effect of safety and protection. Air intake is connected with the input of Soft start - up valve. If coil is energized, 3/2 way valve opens. At this time, a little is equal the half of the input pressure, Soft start - up valve completely opens and the flow at this time reaches the highest value of itself. When the coil is de-energized, air intake P closes, the air returns to R orifice through reflux valve and is quickly exhausted. The pressure of the system falls to zero, which protects the whole system.

Attention:

Manually adjust the "+" and "-" throttle screw at the bottom of the soft start-up valve as per the requirement of start speed. It shall go slowly, otherwise sudden acting of the product or system shall be caused with a heavy impact.

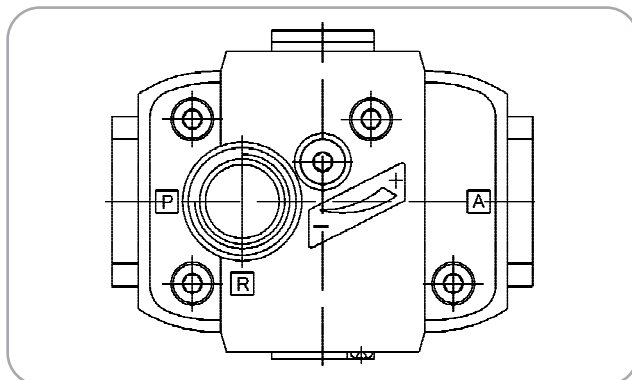

AC Air Source Treatment Unit

Inner structure drawing:

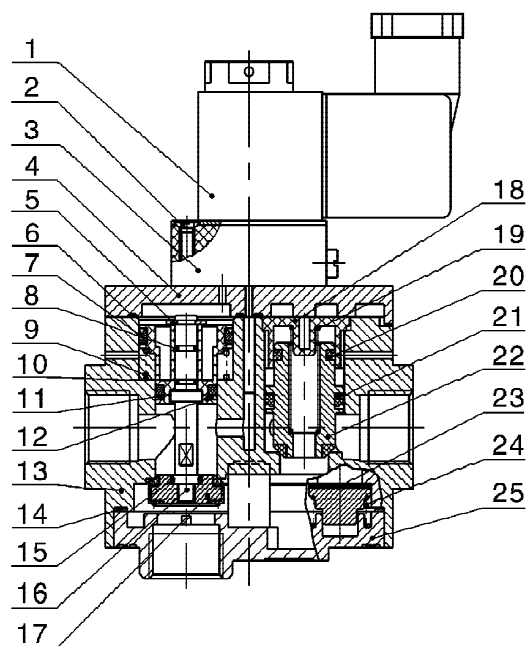

No	Code	No	Code
1	coil set	14	seal
2	sunk screw	15	O ring
3	lead head set	16	valve rod
4	body cover	17	spool 1
5	split washer	18	cover
6	seal	19	spring
7	Y seal	20	Y seal
8	O ring	21	Y seal
9	spring	22	piston 2
10	O ring	23	spool 2
11	Y seal	24	spring
12	piston 1	25	bottom cover
13	valve body		

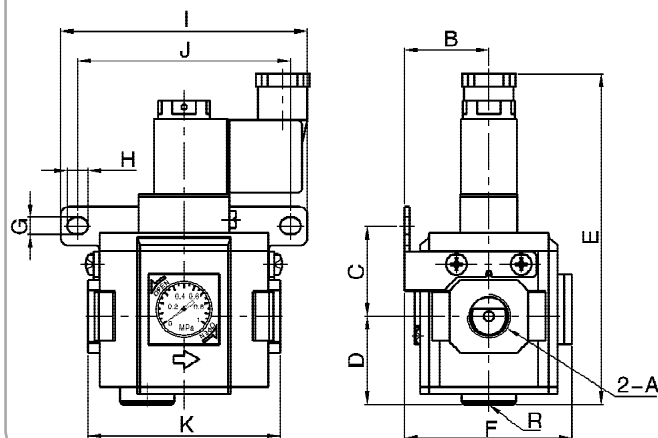

Type	AV200		AV300		AV400	
Symbol	01	02	02	03	03	04
A	1 / 8"	1 / 4"	1 / 4"	3 / 8"	3 / 8"	1 / 2"
B	24.5		32.5		40.5	
C	30.5		34.5		39	
D	30		34		40.5	
E	123.5		130		142.5	
F	57		64.5		80	
G	5.5		6.5		8.5	
H	8		8		11	
I	80		95		120	
J	67		82		102	
K	59		74		90	
R	1/4		3/8		1/2	