

Speed Controls

WSU SERIES



Product features

Used to control the speed of the working equipment
Because of the resin body and metal body rotation lead to the direction is free

Speciality

Fluid	Air /no other gases or liquids)
Operating Pressure	0.1~1 MPa (15~150psi)
Max Pressure	-1.8 MPa
Operating Temperature	-60°C (32-140°F)
Applicable Tube	PU Polyurethane and Nylon

Ordering Code

W	PC	8	-	01	-	*
(1)	(2)	(3)	(4)	(5)		

Metric Size

Code	4	5	6	7	8	9	10	11	12	13	14	15	16
Tube Outer Diameter mm	φ4	φ5	φ6	φ7	φ8	φ9	φ10	φ11	φ12	φ13	φ14	φ15	φ16

Inch Size

Code	5/32	3/16	1/4	5/16	3/8	1/2
Tube Outer Diameter mm	φ5/32	φ3/16	φ1/4	φ5/16	φ3/8	φ1/2

(4) Thread type and size

Metric Size

Code	M5	M6	M8	M10	M12	M12A	M14	M16	M20
Thread	M5*0.8	M6*1	M8*1	M10*1	M12*1.25	M12*1.5	M14*1.5	M16*1.5	M20*1.5

55° Taper Pipe Thread (NPT)

Code	01	02	03	04	06
Thread	R1/8	R1/4	R3/8	R1/2	R3/4

55° Taper Pipe Thread (NPT)

Code	G01	G02	G03	G04	G06
Thread	G1/8	G1/4	G3/8	G1/2	G3/4

UNF

60° American Standard Taper Pipe Thread (NPT)

Code	U10	NO1	NO2	NO3	NO4	NO6
Thread	10-32UNF	NPT1/8	NPT1/8	NPT1/4	NPT1/2	NPT3/4

Note: The external dimension of fitting size is connected the outer diameter odd no. (φ5, φ7, φ9, φ11, φ13) will be suit φ6, φ10, φ12, φ14

Speed Controls

WSU SERIES

Dimensions

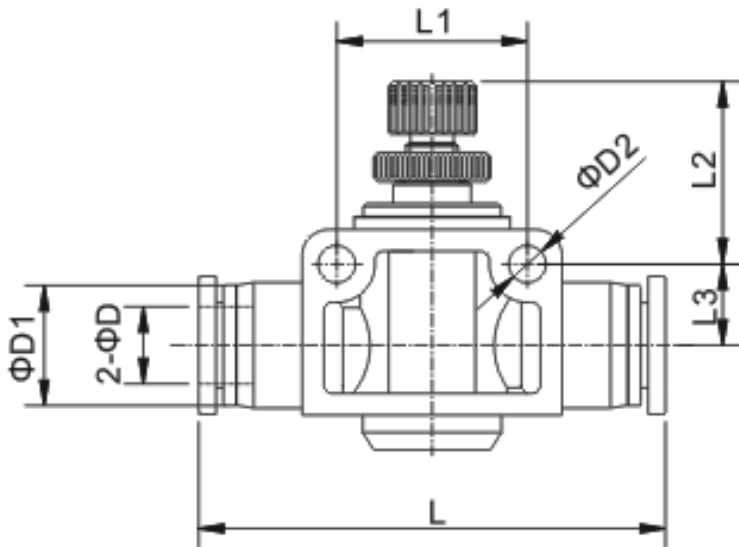

MODEL	φD	φD1	L1	L2	L3	φD1	L1
WSU04	4	10.5	40.5	16	6.5	3.2	14
WSU06	6	12.5	48.7	25.5	8.5	4.3	20
WSU08	8	14	54.4	25	9.5	4.3	22
WSU10	10	18	64.3	29.5	10.5	4.3	26
WSU12	12	20.6	74.6	27.5	13	4.3	32
WSU5/32	5/32	10.5	40.5	16	6.5	3.2	14
WSU3/16	3/16	10.5	40.5	16	6.5	3.2	14
WSU1/4	1/4	12.5	48.7	25.5	8.5	4.3	20
WSU5/16	5/16	14	54.4	25	9.5	4.3	22
WSU3/8	3/8	18	64.3	29.5	10.5	4.3	26
WSU1/2	1/2	20.6	74.6	27.5	13	4.3	32